



## Qualifications:



TS16949



ISO9001



DOT



ECE



INMETRO



GCC



BIS



SNI



SONCAP

## TABLE OF CONTENTS

### PCR



HF805 .....P1



HF201 .....P3

### SUV



VIGOROUS AT601 .....P5



VIGOROUS MT601 .....P6



VIGOROUS HT601 .....P7

### LIGHT TRUCK



SUPER2000 .....P8

### WINTER



Win-turi 211 .....P9



Win-turi 212 .....P10



Win-transit .....P11



ULTRA HIGH PERFORMANCE &  
ASYMMETRICAL PATTERN DESIGN

## HF805



15-20 Inch    Speed Rating: V-W  
35-55 Series    UTQG: 280AAA-400AA

### Features

Four wide circumferential grooves, lateral grooves with fine sipes and continuous block patterns on shoulder

Variable pitch tread design

Jointless Nylon Band

Silica tread compound

Rim protector

### Benefits

Provide efficient water evacuation, outstanding wet performance and enhanced stability at high speed cornering

Superior comfort and quiet ride

Improve tread stiffness and uniformity and deliver high speed stability

Provide better performance on wet surface and reduce rolling resistance

Protect wheels from curb damage



### Stability

Continuous block patterns on shoulder reduce pattern deformation during driving with prompt response and enhanced stability at high speed cornering



### Water Evacuation

Four wide circumferential grooves deliver efficient water evacuation and prevent aquaplaning



Lateral grooves with fine sipes provide outstanding wet performance



Jointless Cap-Ply

Jointless bead wire and high density nylon improve high speed stability & maximize steering response

**Improve** HIGH SPEED STABILITY

Multi-inner radius improves driving control while assuring performance at high speed

**Improve** CONTROL



Special rim protector protects wheels from curb damage



# HIFLY TIRES

PROVIDE A QUIET  
COMFORTABLE  
AND SAFE RIDE

## HF201



12-16 Inch Speed Rating: T-V  
50-80 Series UTQG: 400AA

### Features

- Special tread compound
- Four wide circumferential tread grooves
- Continuous solid center ribs
- Improved groove and bead profile design
- Optimized variable pitch tread design

### Benefits

- Excellent grip on wet and dry roads
- Deliver excellent performance on wet roads
- Improve directional stability, provide more comfortable experience and prevent irregular wear
- Better ride stability and handling performance
- Superior comfort and quiet ride

Series	Size	Load Index	Speed Rating	UTQG	Series	Size	Load Index	Speed Rating	UTQG	Series	Size	Load Index	Speed Rating	UTQG
50	195/50R15	82	V	400AA	60	215/60R16	99 XL	H	400AA	65	215/65R16	98	H	400AA
	205/50R16	87	V	400AA		215/60R16	95	V	400AA		215/65R16	102 XL	H	400AA
55	165/55R14	72	H	400AA		225/60R16	98	H	400AA		155/70R12	73	T	400AA
	185/55R14	80	H	400AA		225/60R16	102 XL	V	400AA		165/70R12	77	T	400AA
	185/55R15	82	V	400AA	65	165/65R13	77	T	400AA		155/70R13	75	T	400AA
	195/55R15	85	V	400AA		155/65R14	75	T	400AA		165/70R13	79	T	400AA
60	205/55R16	91	V	400AA		165/65R14	79	T	400AA		175/70R13	82	T	400AA
	165/60R13	73	T	400AA		175/65R14	82	T	400AA	70	185/70R13	86	H	400AA
	175/60R13	77	H	400AA		175/65R14	82	H	400AA		165/70R14	81	T	400AA
	165/60R14	75	H	400AA		185/65R14	86	H	400AA		175/70R14	84	T	400AA
	185/60R14	82	H	400AA		175/65R15	84	H	400AA		185/70R14	88	H	400AA
	195/60R14	86	H	400AA	65	185/65R15	88	H	400AA		195/70R14	91	H	400AA
	185/60R15	84	H	400AA		195/65R15	95 XL	H	400AA		205/70R14	95	H	400AA
	185/60R15	88 XL	H	400AA		195/65R15	91	V	400AA		205/70R15	96	H	400AA
	195/60R15	88	V	400AA		205/65R15	94	H	400AA	80	215/70R15	98	H	400AA
	205/60R15	91	V	400AA		205/65R15	94	V	400AA		155/80R13	79	T	400AA
	205/60R16	92	V	400AA		215/65R15	96	H	400AA		185/80R15	93	T	400AA

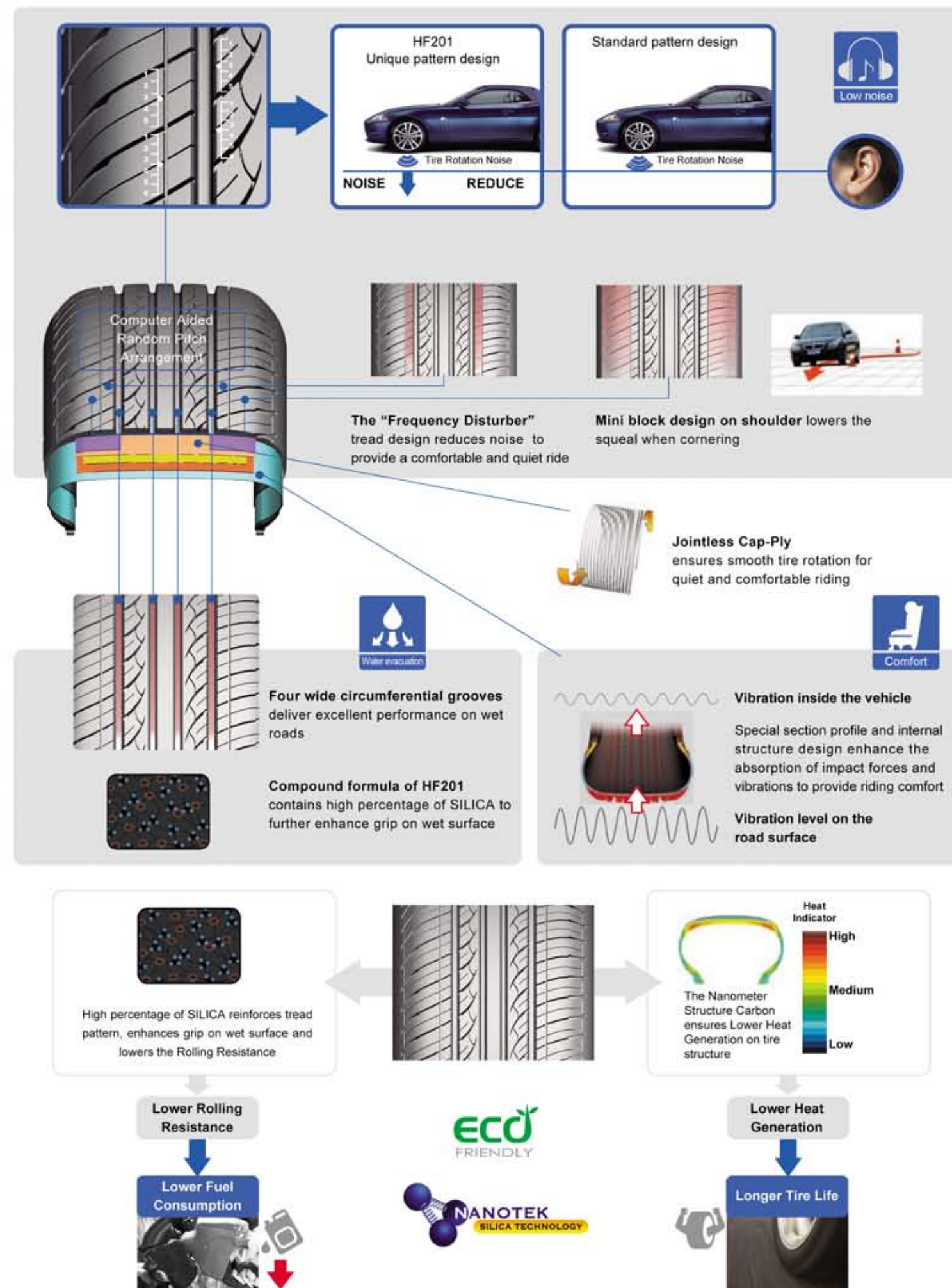



# HIFLY TIRES

ALL-TERRAIN 4 X 4 SUV TIRE  
OUTSTANDING ON AND OFF-ROAD PERFORMANCE

## VIGOROUS AT601

Series	Size	Ply Rating	Load Index	Speed Rating
SUV	31×10.50R15LT	6PR	109	R
	LT265/70R17	10PR	121/118	S
	LT235/75R15	6PR	104/101	R
	LT225/75R16	10PR	115/112	S
	LT245/75R16	10PR	120/116	S
	LT265/75R16	10PR	123/120	R
	LT245/75R17	10PR	121/118	S
	LT215/85R16	10PR	115/112	R
	LT235/85R16	10PR	120/116	R



 15-17 Inch
  Speed Rating: R-S  
 70-85 Series

### Features

Special tread compound and wide footprint

Block tread design with multiple-sipes

Open shoulder grooves

Jointless Nylon Band

Strong structure design

### Benefits

- Enhance tread life and deliver excellent braking on wet and dry roads
- Provide outstanding off-road traction
- Prevent aquaplaning with enhanced wet grip performance
- Improve tread stiffness and uniformity and deliver high speed stability
- Provide reliability and durability



# HIFLY TIRES

OUTSTANDING PERFORMANCE  
IN EXTREME DRIVING CONDITIONS

## VIGOROUS MT601



Series	Size	Ply Rating	Load Index	Speed Rating
SUV	31X10.5R15LT	6PR	109	Q
	LT235/75R15	6PR	104/101	Q
	LT245/75R16	6PR	120/116	Q



15-16 Inch



Speed Rating: Q



75 Series

### Features

Aggressive pattern design

High void ratio and open shoulder design

Special casing profile and solid shoulder pattern

Reinforced casing construction

### Benefits

- Outstanding traction in all conditions
- Excellent resistance to aquaplaning and self-cleaning performance
- Enhanced traction and cornering performance
- Superior overall resistance to damage



# HIFLY TIRES

DELIVER GRIP AND LONG TREAD WEAR  
FOR ALL-SEASON HIGHWAY DRIVING

## VIGOROUS HT601



Series	Size	Load Index	Speed Rating
SUV	235/60R16	100	H
	215/65R16	98	H
	235/70R16	106	H
	245/70R16	111	H
	235/75R15	108	H

### Features

Four circumferential grooves and open shoulder slots

High-density sipes with silica compound

Variable pitch pattern and optimized footprint design

Solid center ribs

Jointless Nylon Band

15-16 Inch

Speed Rating: H

60-75 Series

### Benefits

- ▶ Prevent aquaplaning with enhanced wet grip performance
- ▶ Deliver a smooth ride, lower noise and improve traction on dry and wet roads
- ▶ Superior comfort and quiet ride
- ▶ Provide steering stability and deliver a comfortable ride
- ▶ Improve tread stiffness and uniformity and deliver high speed stability



# HIFLY TIRES



**LIGHT TRUCK TIRE WITH  
ENHANCED DURABILITY & MILEAGE**

## SUPER2000

Series	Size	Ply Rating	Load Index	Speed Rating
LT	155R12C	8PR	88/86	Q
	155R13C	8PR	90/88	Q
	165R13C	8PR	94/92	R
	185R14C	8PR	102/100	R
	195R14C	8PR	106/104	R
	195R15C	8PR	106/104	R
	175/65R14C	6PR	90/88	T
	205/65R15C	6PR	102/100	T
	195/65R16C	8PR	104/102	T
	205/65R16C	8PR	107/105	T
	215/65R16C	8PR	109/107	T
	225/65R16C	8PR	112/110	T
	235/65R16C	8PR	115/113	T
	165/70R13C	6PR	88/86	S
	165/70R14C	6PR	89/87	R
	195/70R15C	8PR	104/102	R



Comfort



Water Evacuation



All season



12-16 Inch



Speed Rating: Q-T

Series	Size	Ply Rating	Load Index	Speed Rating
LT	205/70R15C	8PR	106/104	R
	215/70R15C	8PR	109/107	R
	225/70R15C	8PR	112/110	R
	185/75R16C	8PR	104/102	R
	195/75R16C	8PR	107/105	R
	205/75R16C	8PR	110/108	R
	215/75R16C	10PR	116/114	R

### Features

Reinforced structure composed of two steel belts and full nylon protector

Zigzag vertical groove and open horizontal groove arrangement with sipes

Special abrasion-resistant tread compound

Variable pitch pattern

### Benefits

- Deliver extra puncture resistance and robust load bearing capacity
- Provide excellent wet and dry grip
- Provide enhanced mileage with reduced heat
- Superior comfort and quiet ride



# HIFLY TIRES

ASYMMETRICAL  
STUDLESS WINTER TIRE

## Win-turi 211



Series	Size	Load Index	Speed Rating
45	225/45R17	94XL	H
50	195/50R15	86XL	H
	185/55R15	86XL	H
	195/55R15	85	H
55	195/55R16	91XL	H
	205/55R16	91	H
	215/55R16	97XL	H
	185/60R14	82	T
	185/60R15	84	T
60	195/60R15	88	H
	205/60R16	92	H
	215/60R16	99XL	H
	175/65R14	82	T
	185/65R14	86	T
65	185/65R15	88	T
	195/65R15	91	T
	205/65R15	94	H



14-17 Inch



Speed Rating: T-H



45-65 Series

### Features

Silica tread compound

Four longitudinal grooves and deep lateral slots

Asymmetrical pattern design

Optimized tread block and sipe

### Benefits

- Provide better performance on wet surface and reduce rolling resistance
- Provide extra grip and stability in deep snow conditions
- Excellent braking and traction performance
- Outstanding traction in snow conditions



# HIFLY TIRES

EXCELLENT GRIP AND HANDLING  
IN ALL WINTER CONDITIONS

## Win-turi 212



Series	Size	Load Index	Speed Rating
45	225/45R17	94XL	H
	195/50R15	86XL	H
50	205/50R17	93XL	H
	225/50R17	98XL	H
55	185/55R15	86XL	H
	195/55R15	85	H
	195/55R16	91XL	H
	205/55R16	91	H
	215/55R16	97XL	H
60	225/55R17	101XL	H
	185/60R14	82	T
	185/60R15	84	T
	195/60R15	88	H
	205/60R16	92	H
65	215/60R16	99XL	H
	155/65R14	75	T
	175/65R14	82	T
	185/65R14	86	T
	175/65R15	84	T
	185/65R15	88	T
	195/65R15	91	T
	205/65R15	94	H
70	215/65R16	98	H
	165/70R14	81	T



14-17 Inch

Speed Rating: T-H

45-70 Series

### Features

Outer longitudinal rib block design and inner lateral slots

Silica tread compound

Three longitudinal grooves

Non-through block sipes

### Benefits

- Enhance braking, cornering grip and the removal of water and slush
- Deliver superb traction and lower rolling resistance
- Improve water evacuation and stability in deep snow conditions
- Provide excellent grip, minimise the friction and reduce rolling resistance



# HIFLY TIRES



WINTER COMMERCIAL VAN TIRE

## Win-transit



Series	Size	Ply Rating	Load Index	Speed Rating
65	195/65R16C	8PR	104/102	R
	205/65R16C	8PR	107/105	R
	215/65R16C	8PR	109/107	R
	235/65R16C	8PR	115/113	R
70	195/70R15C	8PR	104/102	R
	215/70R15C	8PR	109/107	R
	225/70R15C	8PR	112/110	R
75	195/75R16C	8PR	107/105	R



Comfort



Water Evacuation



Fuel Efficiency



Snow Handling



15-16 Inch



Speed Rating: R



65-75 Series

### Features

Silica tread compound

Large block tread design

Zigzag grooves and high-density sipes arrangement

Reinforced construction

### Benefits

- Provide better performance on wet surface and reduce rolling resistance
- Enhance traction and handling in snow conditions
- Improve grip performance from wet and frigid surfaces to snow and ice
- Deliver robust load bearing capacity and rugged durability



# Technical File

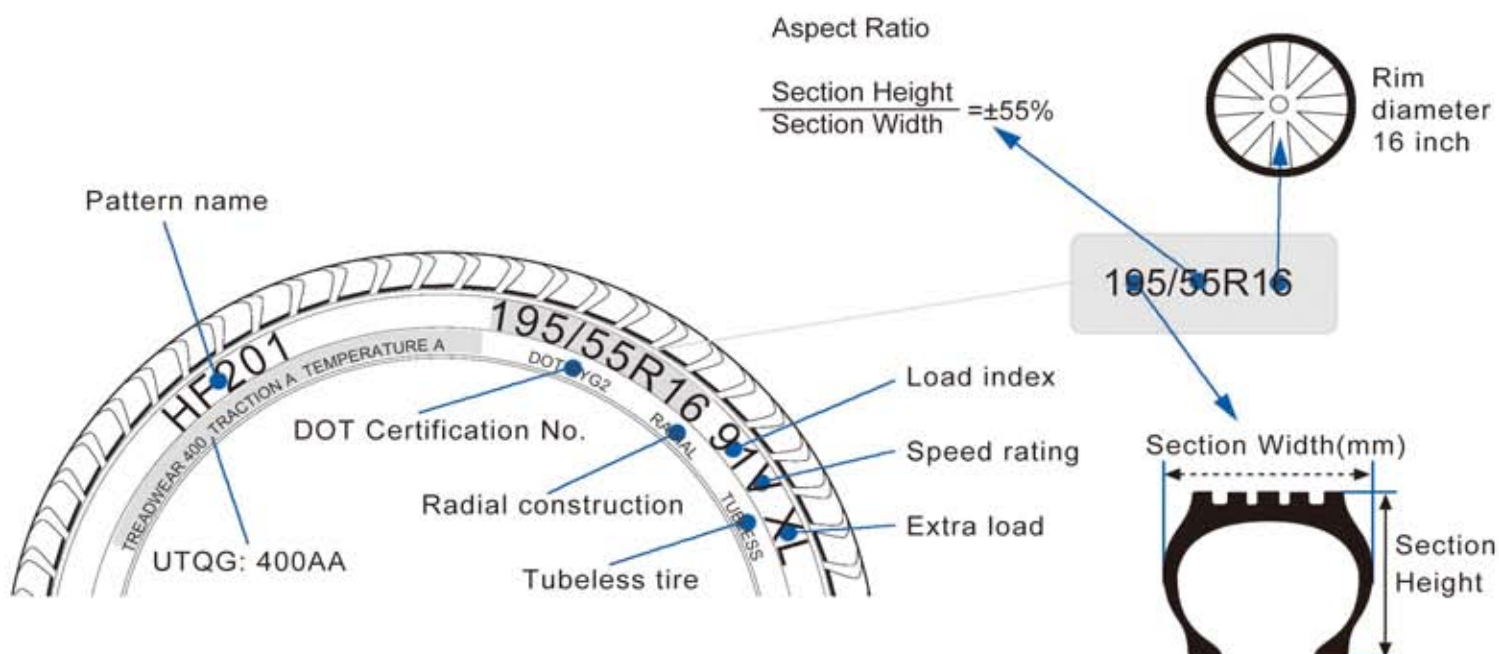

## Speed Symbols

SI	KM/H
B	50
C	60
D	65
E	70
F	80
G	90
J	100
K	110
L	120
M	130
N	140
P	150
Q	160
R	170
S	180
T	190
U	200
H	210
V	240
W	270
Y	300
Z	Above 240

## Load Capacity Index

LI	KG	LI	KG	LI	KG	LI	KG
50	190	70	335	90	600	110	1060
51	195	71	345	91	615	111	1090
52	200	72	355	92	630	112	1120
53	206	73	365	93	650	113	1150
54	212	74	375	94	670	114	1180
55	218	75	387	95	690	115	1215
56	224	76	400	96	710	116	1250
57	230	77	412	97	730	117	1285
58	236	78	425	98	750	118	1320
59	243	79	437	99	775	119	1360
60	250	80	450	100	800	120	1400
61	257	81	462	101	825	121	1450
62	265	82	475	102	850	122	1500
63	272	83	487	103	875	123	1550
64	280	84	500	104	900	124	1600
65	290	85	515	105	925	125	1650
66	300	86	530	106	950	126	1700
67	307	87	545	107	975	127	1750
68	315	88	560	108	1000	128	1800
69	325	89	580	109	1030	129	1850
						130	1900



## Tire Usage Tips:

### 1. Tire Tread Depth:

**Change tyres before the tread depth is worn to 1.6mm.**

Make sure to regularly check the tread depth of tyres and replace them when they are worn. This will guarantee maximum traction and grip, helping avoid risk of aquaplaning and it will also affect the braking distance etc..

## 2. Tire Balancing:

Tires should be balanced when they are mounted on wheels for the first time or when they are remounted after repair. Tire balance should be checked at the first sign of a vibration or shimmy. Unbalanced tires cause vibration, which can lead to driver fatigue, irregular and premature wear, as well as unnecessary wear to the vehicle's suspension.

### 3. Tire Pressure:

Check the pressure of tyres, including the spare, monthly and before any long journey, preferably when tyres are cold. If they are hot, it is advisable to add 4-5 psi to the pressure recommended by the vehicle manufacturer.

Correct tyre pressure reduces the risk of losing control of your vehicle. It also protects your tyres from premature wear and irreversible damage to the internal construction. Tyre pressure can drop due to small perforations, the natural escape of air through the tyre's components or even from a decrease in ambient temperatures. So it is important to check it once a month.

#### 4. Wheel Alignment:

### ENSURE SAFETY WITH CORRECTLY ALIGNED WHEELS AND AXLES

A vehicle is properly aligned when all suspension and steering components are sound and when the tire and wheel assemblies are running straight and true. If you notice uneven tread wear, this could be due to a misalignment and must be serviced by a professional. It's important to ensure correct alignment to get the best road handling, protect your tyres from irregular and / or rapid wear and save fuel.

### 5. Rear Tyres:

For optimum efficiency, regularly check the pressure and condition of your tyres, especially during tyre rotation as many vehicles specify different pressure on the front and rear axle.

**FOR COMPLETE CONTROL, FIT YOUR NEW TYRES TO THE REAR AXLE.**

Rear wheels are not connected to your steering wheel, which makes it extremely difficult to judge their grip while driving. So for your safety, always fit new, or the least worn tyres to the rear wheel positions to ensure:

**Better control in emergency braking or tight corners.**

Less risk of losing control of your vehicle, especially on wet surfaces.

**Better road holding, particularly in difficult situations, whether your car is front or rear wheel drive.**

### 6. Tire Repair:

Tire repairs should be carried out by a trained tire professional. Proper repair procedure will include dismounting the tire from the wheel for a thorough inspection to check for damage, and the use of a patch and plug to repair any punctures that fall within the limits and guidelines for repair.

### 7. Tire Rotation:

While many people are capable of rotating their own tires, it is quick, easy and secure to let a professional do it for you. Your vehicle's owner's manual will specify the proper rotation pattern and schedule for your vehicle. If a specific schedule is not indicated, it is a good rule of thumb to rotate your tires every 8,000 to 10,000 kilometers.

